



Automatic Boiler End Beveling Machines - ORBIT

PROFIT FROM OUR TOOL EXPERTISE

Linsinger's latest innovation in the field of high-performance beveling, provides the world's first fully automatic boiler end-beveling line to our customers.

The new machine type covers a diameter range from 1,800mm (70") up to 7,000mm (275"). Wall thicknesses from 6 – 60mm (0,2 – 2,3") are processable. Optional minimum quantity lubricant spray nozzles ensure economic machining of Stainless Steel and high alloyed materials.

Various profile types (N/V/X/Y/J) can be realized. Due to the special angle head, individual profiles and geometries can be milled with one cutterhead. The integrated aligning and downholder units, and the copying function of the milling unit, ensure a constant web-flow along the circumference of the boiler end even with "oval" shaped boiler ends.

After loading via an inlet conveyor, the Boiler Ends or cups are automatically transported into the machining area, where the chamfering cycle takes place. After machining, the heads are automatically discharged and ready for further transport.

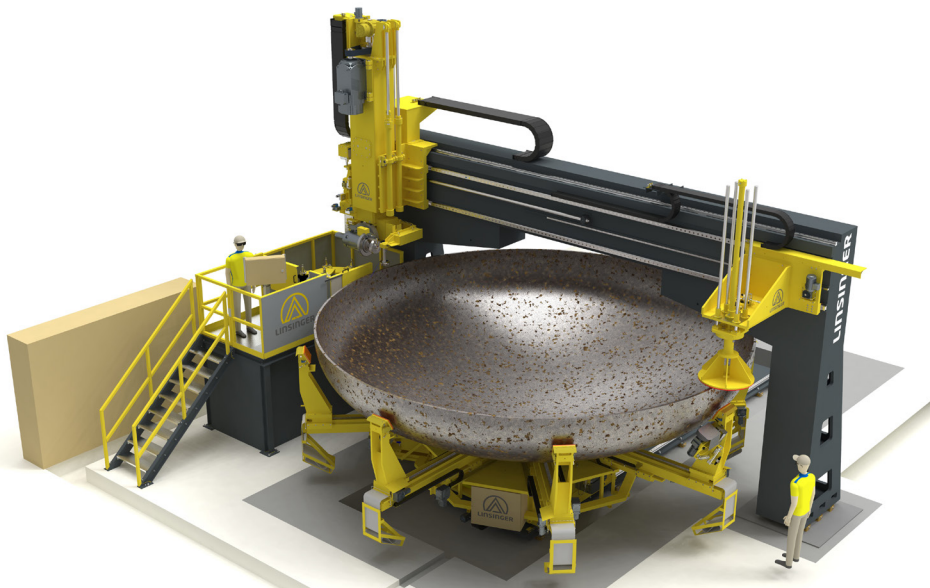

YOUR BENEFITS:

- Fully automatic machining cycle
- High beveling performance
- Easy machine setup for every diameter
- Automatic and precise alignment of boiler ends
- Precise and fast welded seam preparation
- Various kinds of profiles available (V/X/Y/J...)
- Automatic tool changer function available

TECHNICAL DATA

Beveling Time
12 min

OD 7.000 mm
(275")
Carbon Steel

LINSINGER BOILER END BEVELLING MACHINE: ORBIT 7000

APPLICABLE FOR:

DIAMETER	1,800 – 7,000mm (70 – 275")
WT	6 – 60mm (0,2 – 2,4") – thicker materials upon request
WORKPIECE	Max. 30,000kg – higher loads upon request
MATERIAL	Carbon Steel, Stainless Steel, High Alloyed Materials

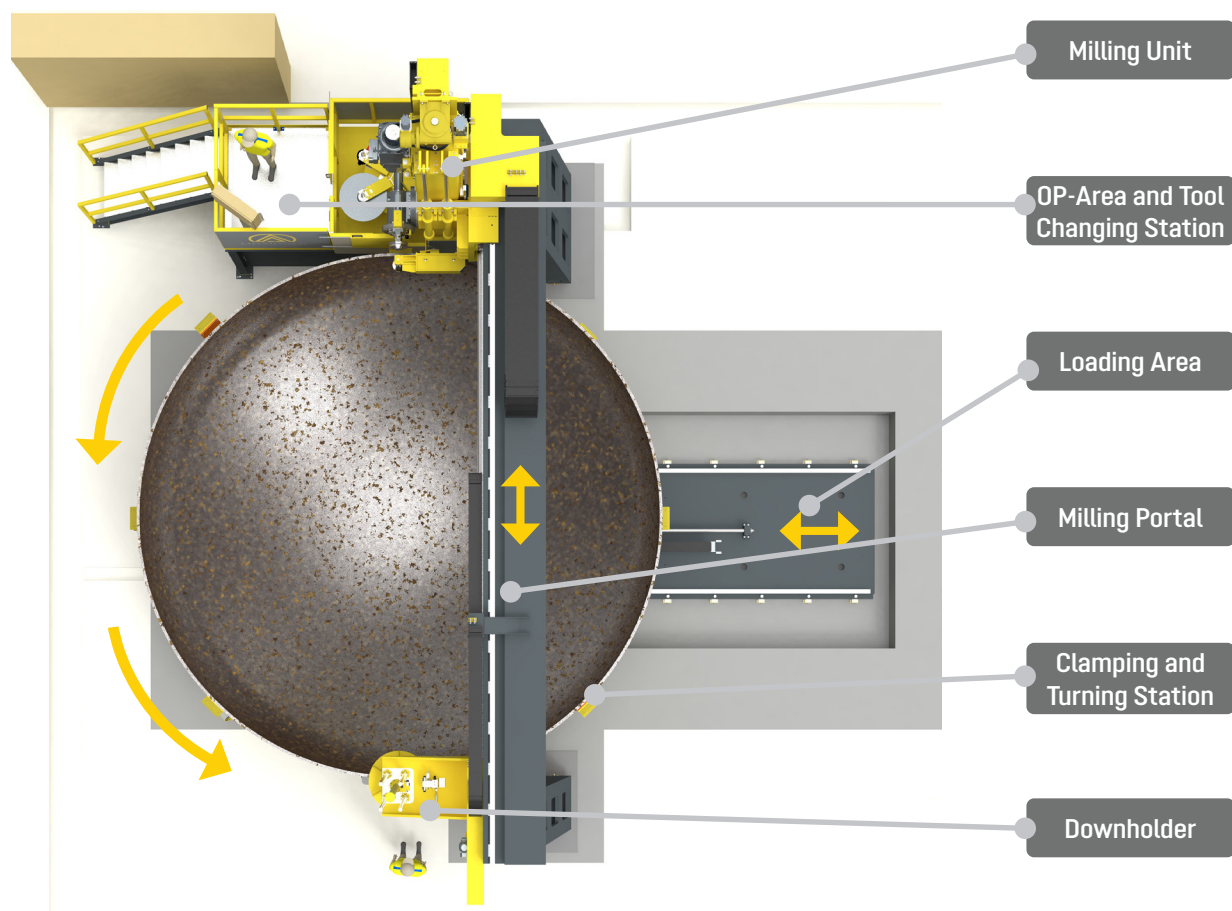

AVAILABLE OPTIONS

- Milling of press tools for vessel heads
- Machining of centric or concentric holes by drilling or milling
- Threading and bevelling of holes
- Bevelling of holes
- Plane milling of flanges or surfaces after welding
- Milling of spherical tank segments

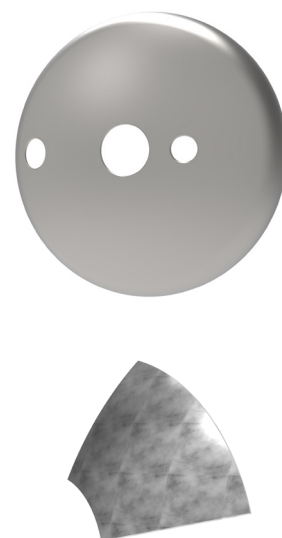

The details, data and drawings etc. contained in all brochures/catalogues of Linsinger are purely of informational nature and these details explicitly cannot be interpreted in order to derive any claims whatsoever against Linsinger. The details etc. are only binding for Linsinger if they expressly become part of a contract concluded between Linsinger and the Buyer or if they are confirmed in writing by Linsinger in the course of an order confirmation.